EZWALL

HYDROFACTOR



Installation Guide

EZWALL Coatings Inc.

1001 Forest Avenue

Dallas, TX 75215

Tel: (214) 428-1886

www.ezwallcoatings.com

ATTENTION:

EZWALL products are intended for use by experienced, qualified, professional contractors and not DIY consumers. HydroFactor and other EZWALL products are components larger wall systems and should be installed in accordance with those specifications and EZWALL's instructions. **DISCLAIMER:**

EZWALL assumes no liability for its products applied improperly, or by unqualified persons or entities, or as part of an improperly designed or constructed building. Improper use of EZWALL products or use as part of an improperly designed larger assembly or building may result in damage to the EZWALL products, other components or to the building itself.

EZWALL COATINGS INC. DISCLAIMS ALL WARRANTIES EXPRESSED OR IMPLIED EXCEPT FOR EXPLICIT LIMITED WRITTEN WARRANTIES

SIGNED AND ISSUED BY THE MANUFACTURER, EZWALL COATINGS INC.



SUMMARY

General:

Installation of the HydroFactor WRB system must comply with this report and the manufacturer's published installation instructions. The manufacturer's published installation instructions must be available at the job site at all times during installation.

HydroFactor WRB must be installed on the exterior side of the vertical exterior walls over the exterior sheathing. Surfaces must be free of all bond-inhibiting materials, including dirt, oil and other foreign matter. HydroFactor - C and HydroFactor - J must be applied only when the surface and ambient temperatures are 40 F (4 C) and rising during the application and drying period. Working time will decrease as surface and ambient temperatures increase.

HydroFactor WRB must not be installed on damp surfaces, below-grade surfaces subject to water immersion. Damaged sheathing must be removed and replaced. Sheathing must be installed as required by the applicable code. HydroFactor WRB must be covered with an exterior wall finish complying with the requirements of the applicable code or a current ICC-ES evaluation report.

Hydrofactor-J is trowel or roller-applied over all sheathing joints, rough openings, and inside and outside building corners. HydroFactor tape/mesh is then immediately applied over the Hydrofactor-J while wet and troweled smooth. HydroFactor-J is then troweled over the HydroFactor Tape. Sheathing joints, rough openings and corners require a minimum 6-inch (101 mm) width of mesh. The system must not be applied over irregular surfaces. The application thickness of hydroFactor-J must not exceed 1/16 inch (1.6 mm).

The substrate must be prepared as described. HydroFactor-C is applied on remaining substrate in two coats to a total wet thickness of 12 mils [0.012 inch (0.30 mm)], using a 3/4-inch (19.1 mm) nap roller. The first coat must tack-up before application of the second coat. The coating must not be applied in rainy conditions. HydroFactor-C may also be sprayer-applied, in one or two coats, to a total wet thickness of 12 mils [0.012 inch (0.30 mm)].

Installation at Sheathing Joints

STEP 1 OF 4
Using a trowel, apply **HydroFactor J** to all joints.



STEP 2 OF 4
Embed 4" mesh into the first coating of **HydroFactor J**.

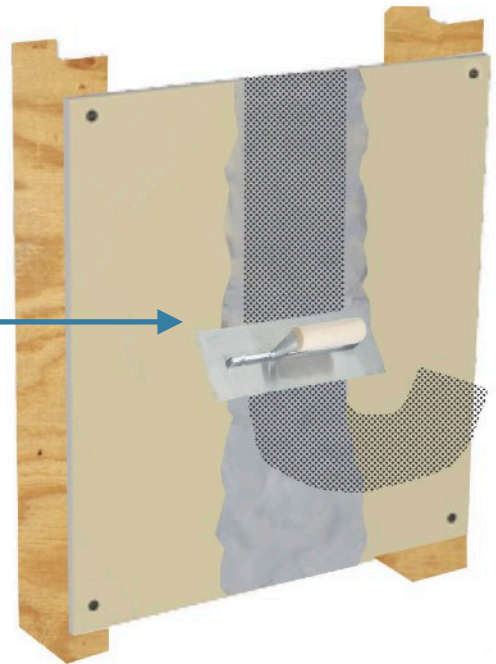

Installation at Sheathing Joints

STEP 3 OF 4

Using a trowel, apply a second layer of **HydroFactor J** to thoroughly cover mesh.

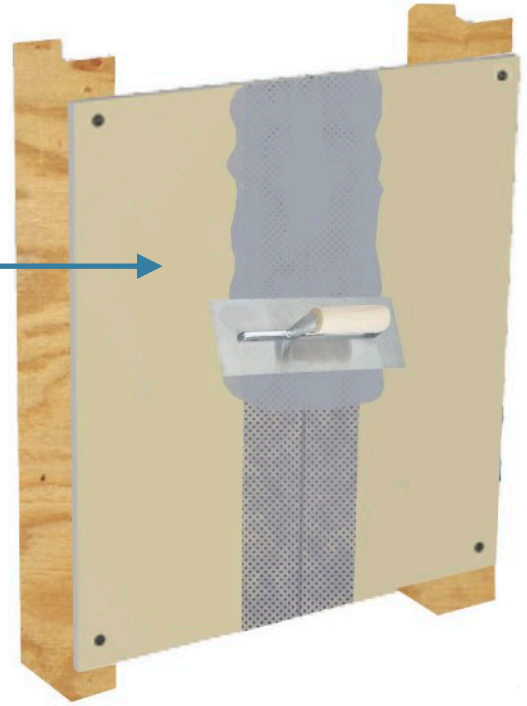

STEP 4 OF 4

Using a Roller Brush OR trowel, apply **HydroFactor C** to the entire face of the sheathing.

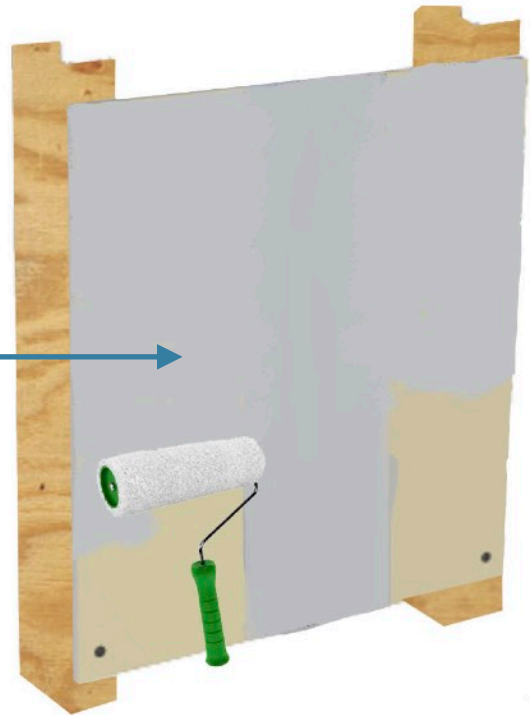

Installation at Inside Corner

STEP 1 OF 4
Using a trowel, apply **HydroFactor J** to the inside intersecting corners.

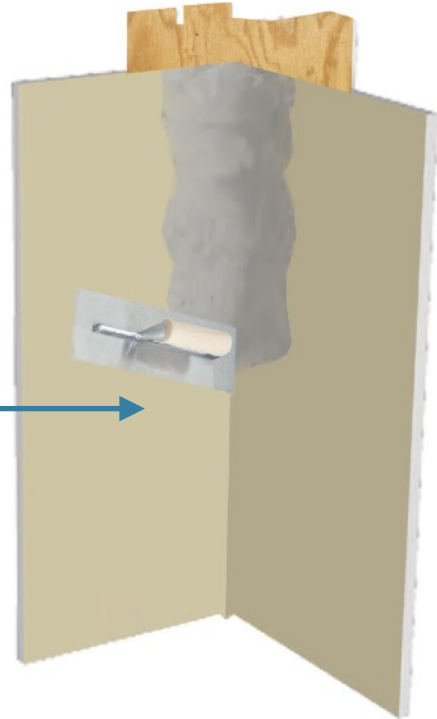

STEP 2 OF 4
Embed 6" mesh into the first coating of **HydroFactor J**.

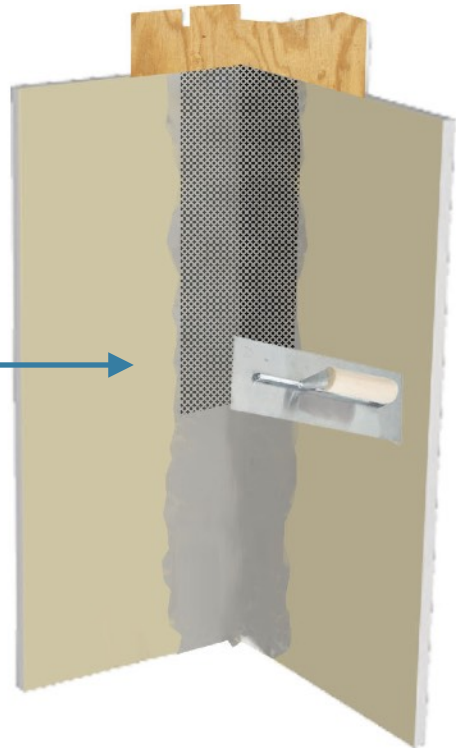

Installation at Inside Corner

STEP 3 OF 4
Using a trowel, apply a second layer of **HydroFactor J** to thoroughly cover mesh.

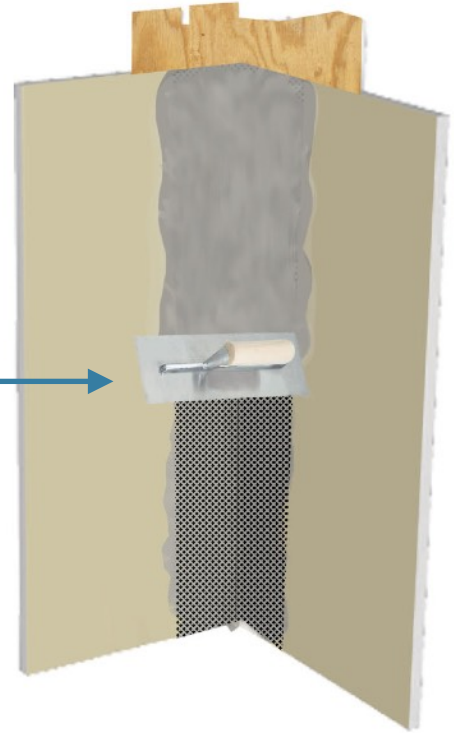

STEP 4 OF 4
Using a Roller Brush OR trowel, apply **HydroFactor C** to the entire face of the sheathing.

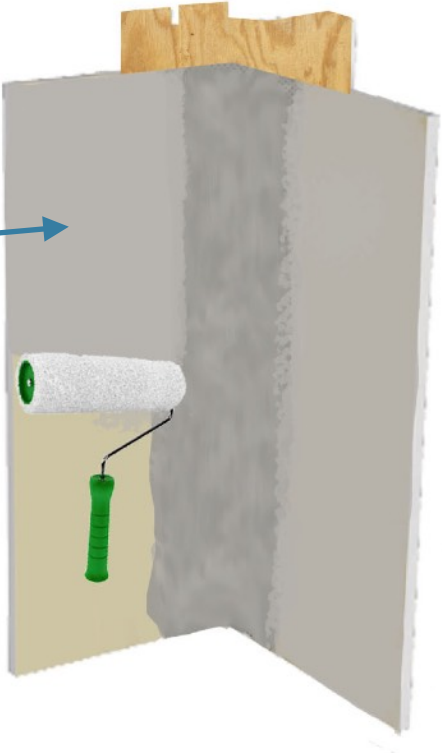

Installation at Outside Corner

STEP 1 OF 4

Using a trowel, apply **HydroFactor J** to the outside intersecting corners.

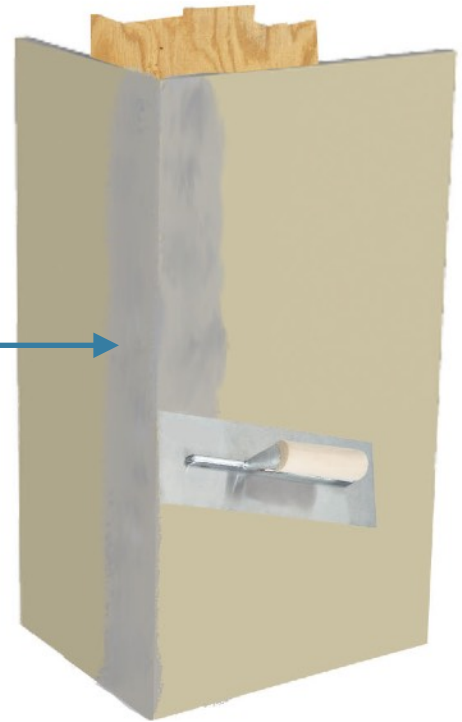

STEP 2 OF 4

Embed 6" mesh into the first coating of **HydroFactor J**.

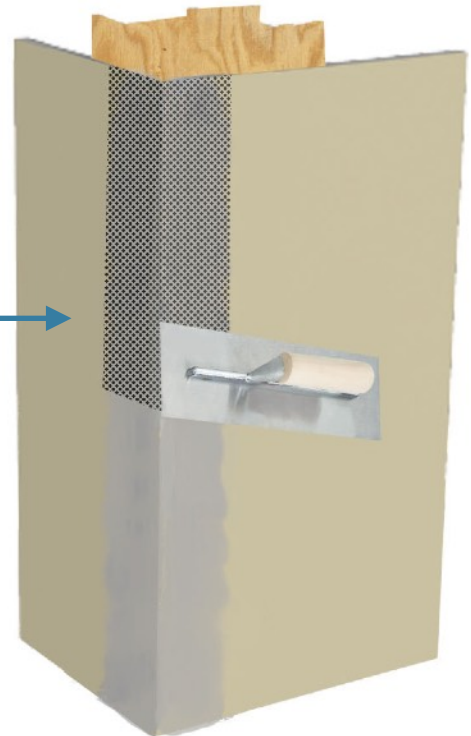

STEP 3 OF 3

Using a trowel, apply a second layer of **HydroFactor J** to thoroughly cover mesh.

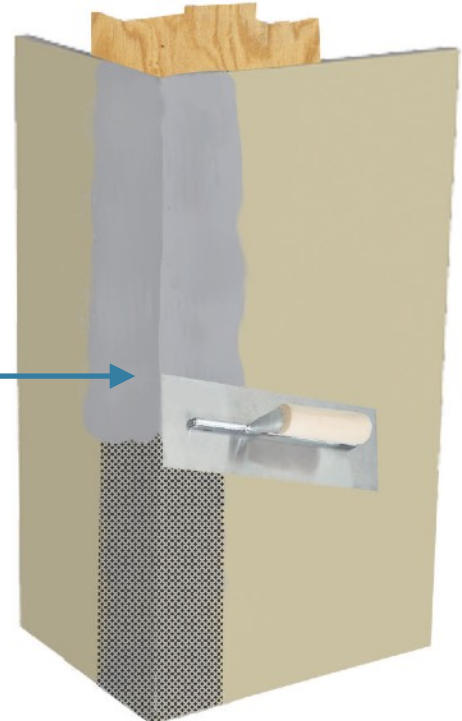

STEP 4 OF 4

Using a Roller Brush OR trowel, apply **HydroFactor C** to the entire face of the sheathing.

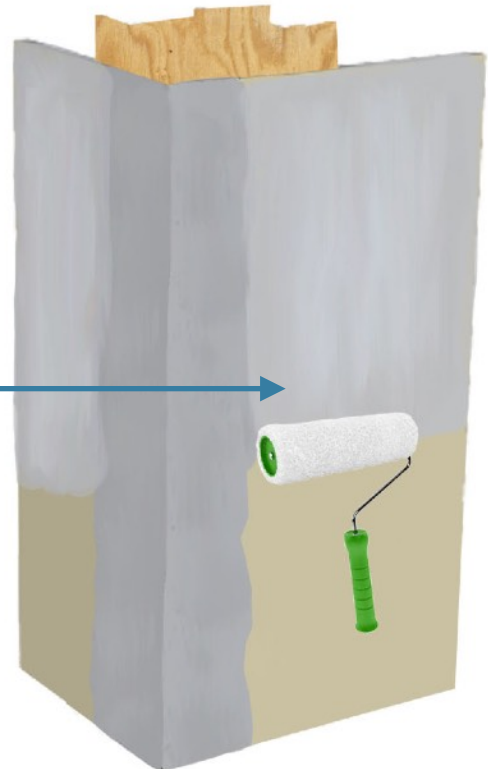

Installation at Rough Openings

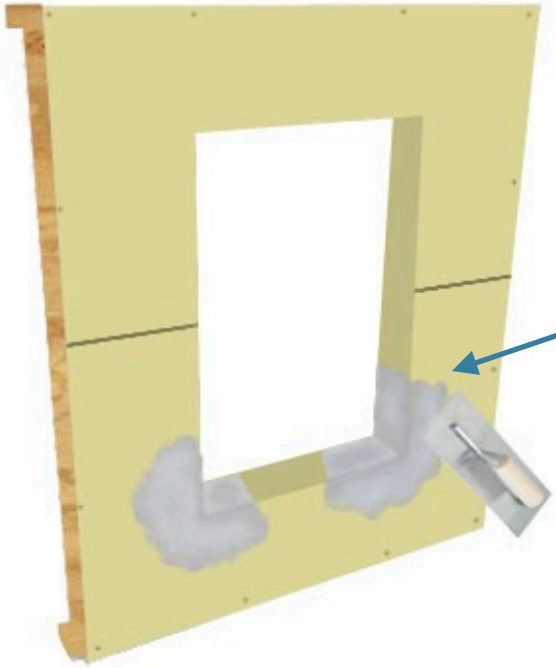

STEP 1 OF 7

First, using a trowel, apply **HydroFactor J** to the **BOTTOM** corners of the rough opening.

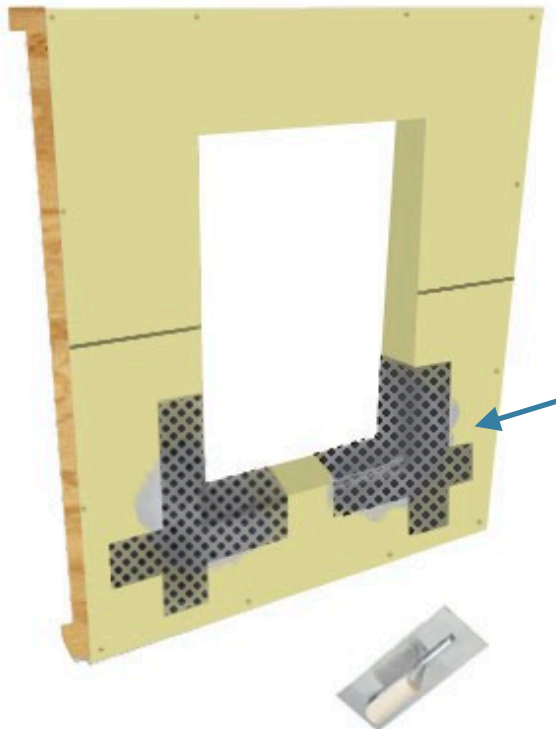

STEP 2 OF 7

Embed **CORNER** mesh into the first coating of **HydroFactor J** in the bottom corners.

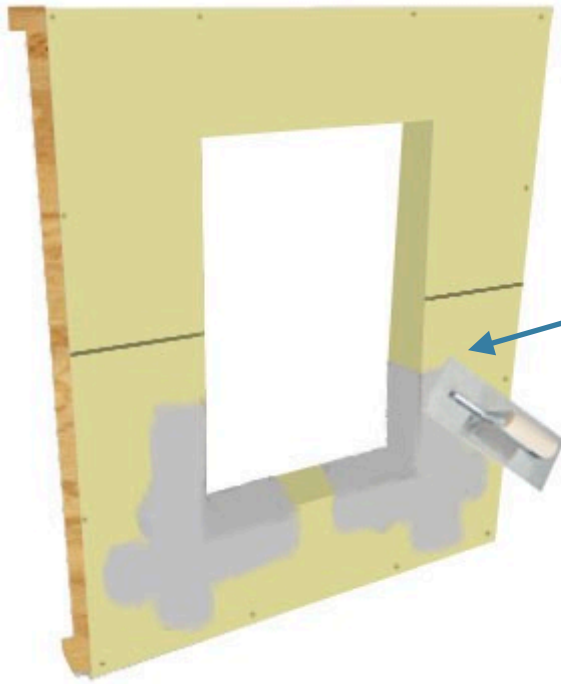

STEP 3 OF 7

Using a trowel, apply a second layer of **HydroFactor J** to thoroughly cover mesh.

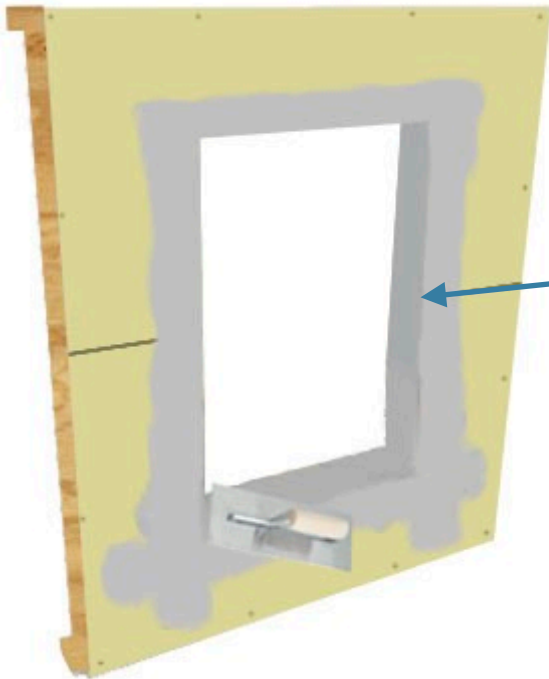

STEP 4 OF 7

Using a trowel, apply **HydroFactor J** **INSIDE** the rough opening and onto the face of the sheathing.

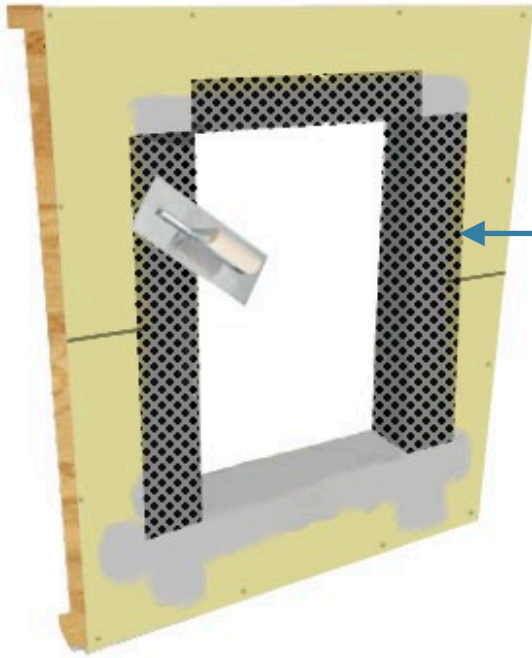

STEP 5 OF 7
Embed 6" mesh into the coating of **HydroFactor J**.

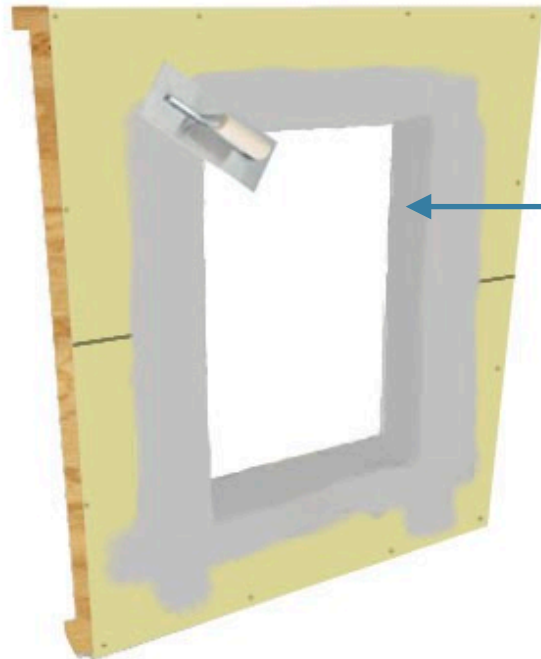

STEP 6 OF 7
Thoroughly cover mesh with **HydroFactor J**.

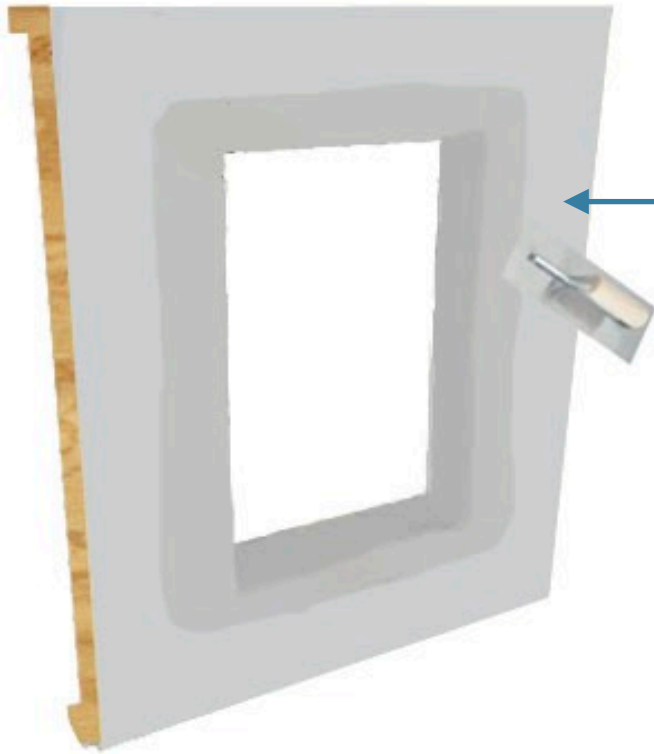

STEP 7 OF 7

Using a Roller Brush
OR trowel, apply
HydroFactor C to the
entire face of the
sheathing.